

3

2

3

Aug. 1925  
WINDSOR  
VT.

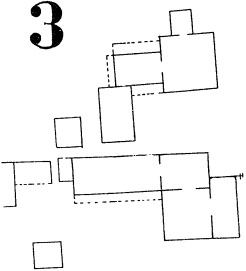

5

C E M E T E R Y

OLD SOUTH CHURCH  
CONGREG.  
REST. FROM  
1870'S ELEC.

MAIN

DRIVE

MUNICIPAL  
BLDG.  
FIRE DEPT. HALL  
COMD. BY  
1st Lt. J. W. B. 1917  
2nd Lt. J. W. B. 1917

DRIVE

OLD MEMORIAL  
M.E. CHURCH  
1870

DURKEE

RIVER

CENTRAL  
(AV)

CENTRAL  
(AV)

MECHANIC  
AV.

JUNK

4

16

19

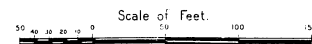

Copyright 1925 by the Sanborn Map Co.